

SCHEDULE OF ACCOMMODATION		
	ACCOMMODATION	PARKING
RESIDENTIAL - FLATS	BLOCK 1 22No. 2-Bed Flats 2No. 2/3-Bed Penthouse Flats	20No. spaces in basement of Block 1 4No. external parking spaces
	BLOCK 2 2No. 1-Bed Flats 2No. 2-Bed Flats 2No. 3-Bed Duplex Apartments	30No. external parking spaces
	BLOCK 4 18No. 2-Bed Flats	
RESIDENTIAL - HOUSES	BLOCK 3 3No. 3/4 Bed Houses	3No. garages in Block 3 3No. private external parking spaces to Block 3
TOTAL RESIDENTIAL	2No. 1-Bed Flats 42No. 2-Bed Flats 2No. 2/3-Bed Penthouse Flats 2No. 3-Bed Duplex Flats 3No. 3/4 Bed Houses	
EMPLOYMENT - OFFICES	TOTAL: 51 No. RESIDENTIAL UNITS	60No. PARKING SPACES (includes 4No. disabled parking spaces)
	BLOCK 5 4No. 1167sq feet (net) Offices	19No. parking spaces
	BLOCK 6 8No. 1250sq feet (net) Offices 4No. 1110sq feet (net) Offices	40No. parking spaces
TOTAL EMPLOYMENT	19108sq feet (net) OFFICES =1775.1 sqm (net)	59No. PARKING SPACES (at 1 space per 30 sqm; includes 5No. disabled parking spaces)

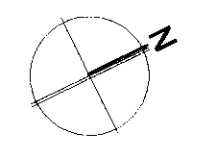
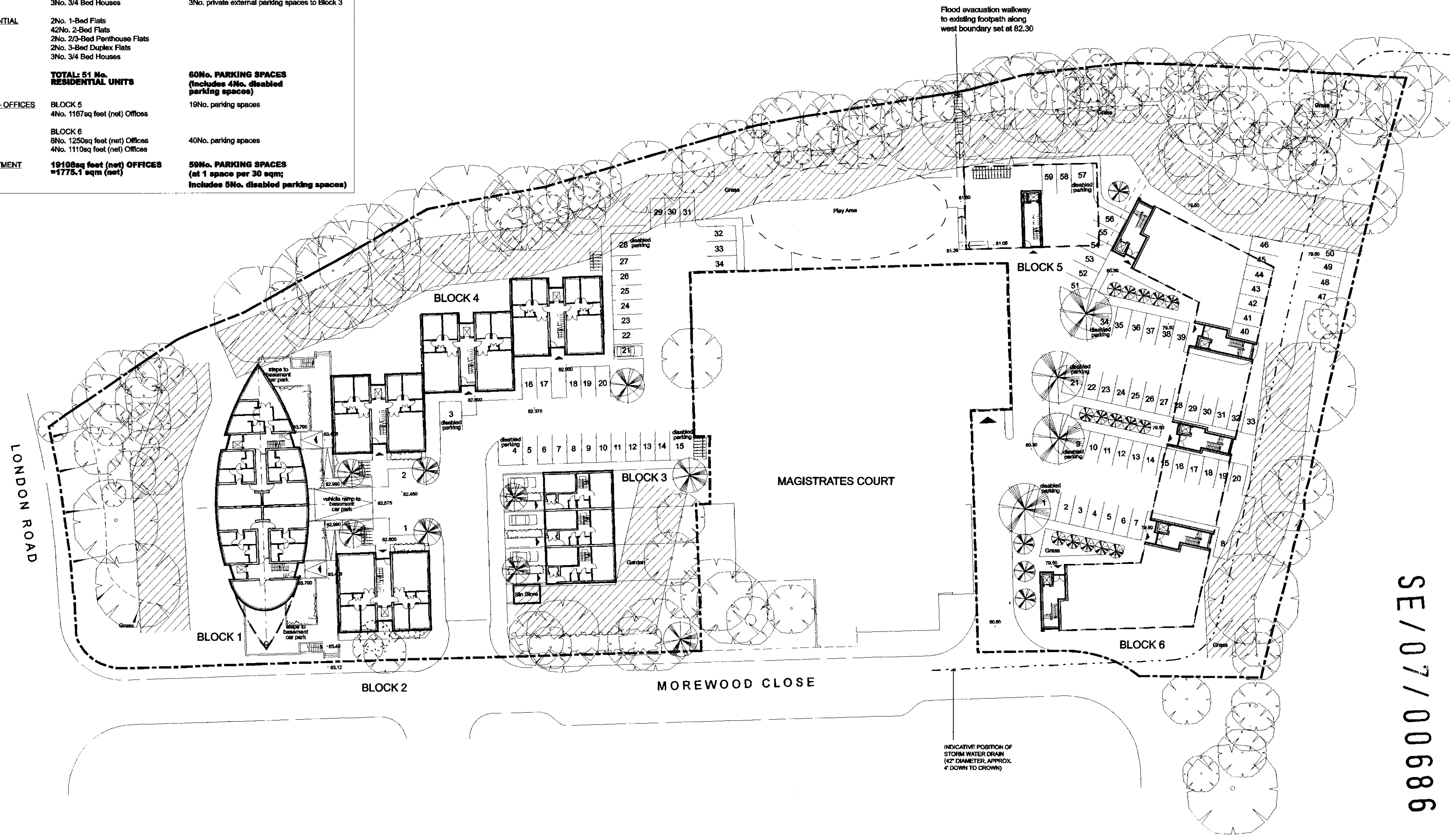

LEGEND

	Proposed new tree
	Existing tree to be retained
	Existing tree to be removed

Revisions			
Number	Date	Author	Checked

SE/07/00686

SEVENOAKS DISTRICT COUNCIL
 COMMUNITY & PLANNING SERVICES
 REC'D 02 MAR 2007

Kent Police - Redevelopment Sites
Morewood Close Sevenoaks

Proposed Site Plan - Ground Floor Level
Showing Block 5 - Alternative

Architects Design Partnership (A) Ltd	Check all dimensions and verify on site. Report any errors or omissions.
Project No: KCT15	Revision No: A2
Scale: 1:500	Date: RF
Block: D031	